

Package Contents

1. 1 x LED Flexible Strip Light
2. 3M Adhesive Backing
3. Fixture instructions



Important Safety Information

Please read these instructions carefully before attempting to install this product. It is advisable to keep these instructions in a safe place for further reference. These products must not be modified; if any modifications are made, it may invalidate the warranty and may render the product unsafe. These LED lights operate on low voltage (12V). **Do not wire the individual LED light fixtures directly to line power. This product is for indoor use only. Keep out of moisture and use only in dry rooms.**

CAUTION : To reduce the risk of fire, electric shock, or injury to persons:

- a) Use only insulated staples or plastic ties to secure cords;
- b) Route and secure cords so that they will not be pinched or damaged when the cabinet is pushed to the wall;
- c) Not intended for recessed installation in ceilings, or soffits.

The low voltage light may be installed under a kitchen cabinet or other built-in furniture when:

- 1) The low voltage Class 2 power supply is located outside the cabinet and is not concealed; and
- 2) The line voltage power supply cord is not concealed or run through openings in the cabinet, walls, ceilings, or floors.

This requirement does not apply to the wiring between the cabinet light and the power unit.

The National Electrical Code (NEC) does not permit cords to be concealed where damage to insulation may go unnoticed. To prevent fire danger, do not run cord behind walls, ceilings, soffits, or cabinets where it may be inaccessible for examination. Cords should be visually examined periodically and immediately replaced when any damage is noted.

Safety Instructions

1. IMPORTANT: Lamp must be installed in accordance with relevant codes and regulations.
2. This product is only suitable for connecting to a 12V DC power source. The light should be mounted onto a secure surface. Position lights where they will not be exposed to steam, splashes, etc.
3. Never exceed the total output of your LED driver.
4. Suitable for cabinet and decorative lighting.
5. When the lamp expires the fixture must be replaced.
6. Class 2 safety extra low voltage (SELV).
7. Be sure to use only approved accessories and drivers.

Accessories:

- SA10314 - LED Flexible Strip Driver Connection Lead 8.2' (2.5m)
- SA10315 - LED Flexible Strip- Inter Connecting Lead 19.69" (500mm)
- SA10316 - LED Flexible Strip- Corner Connection Lead 1.97" (50mm)
- SA10317 - LED Flexible Strip - Inter Connecting Lead 4.92' (1.5m)
- SA40545 - 4 Port ML Connector Expansion Block
- SA10318 - LED Flexible T Shape Strip

Drivers:

- SA40625 - Sensio 120V LED 6W 12V Driver with 4 Port ML Block
- SA40659 - Sensio 120V LED 15W 12V Driver with 12 Port ML Block
- SA40626 - Sensio 120V LED 30W 12V Driver with 12 Port ML Block
- SA40590 - Sensio 120V LED 15W Dimmable Driver 12 Port ML

| | |
|----------------------------|---------------------|
| Wattage | 0.8W |
| Voltage | 12V |
| LED Qty | 12 |
| Lamp Type | LED |
| Kelvin (Cool White) | 5000 |
| Kelvin (Warm White) | 3200 |
| LPW | 45/41 |
| Lifespan | 50000hrs |
| Materials | Transparent Plastic |
| Luminous Flux | 25 |
| Width | 0.31in (8mm) |
| Depth | 0.1in (2.5mm) |
| Length | 11.81in (300mm) |

Solution

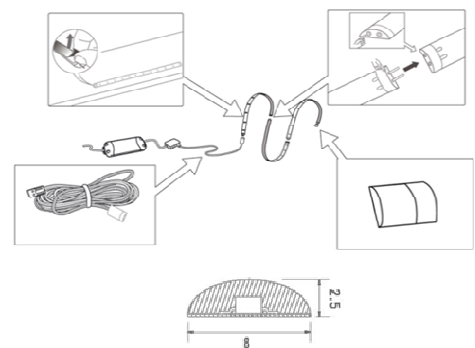
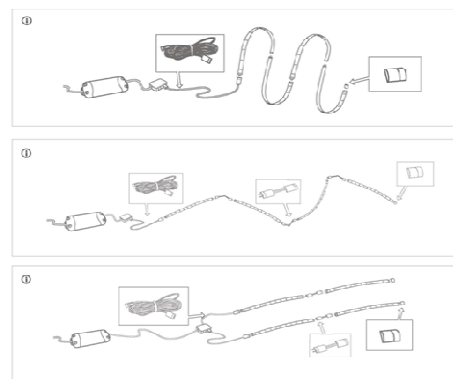

*T" type accessories

